

Line insulator to synthetic rope KUSYS type 1 with suspension threaded bolt M16 rigid

Item number C2371-03

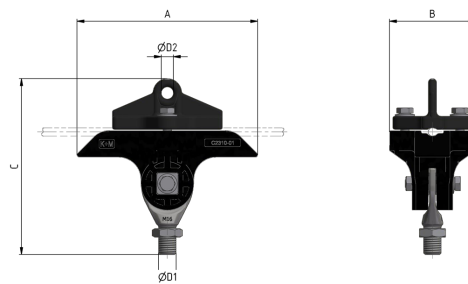

Dimensions

A: 164 mm
B: 78 mm
C: 159 mm
ØD1: M16
ØD2: 11 mm

Material and weight

Material: Kst / INOX / Alu
Weight: 0.7 kg

Loads

Breaking load to Synthetic cable, Parafil type A, Ø = 11.0 mm: 2.45 kN (+20°C) / H: 90 mm
Breaking load to Synthetic cable, Parafil type A, Ø = 13.5 mm: 2.45 kN (+20°C) / H: 90 mm
Breaking load suspension eye : 4.5 kN
Tightening torque for bolts and hex-nuts M8: 17 Nm

Applicable standards

DIN EN 50119
DIN EN 50124-1
DIN EN 50151
CEI / IEC 60060-1

Function

Insulator body for fastening to synthetic cross-spans in straight segments or slight bends. With cable yoke. Threaded bolt rigid, suspension allowing the attachment of various railway, tramway and trolley bus components.

Specifications

Operating voltage: max. 1500 V DC
Cable diameter: 7.0 - 9.5 mm

Comments

The application in overhead contact lines requires a wide insulation of the support structure to the support bases. Only synthetic ropes with protective covers can be clamped. The suspension can be mounted to pipes or ceilings by exchanging the clamp.