

Line insulator to pipe 2" KUSYS type 2 with double suspension eye

Item number C2376-02

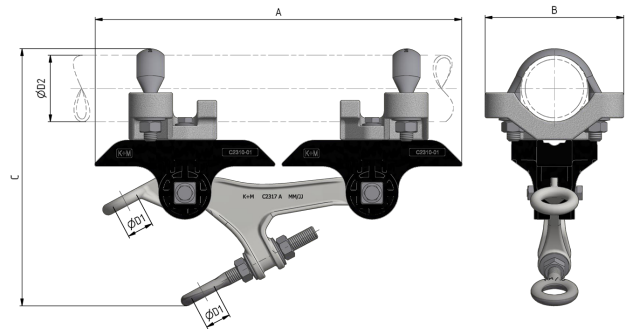

Dimensions

A: 334 mm

B: 126 mm

C: 223 mm

ØD1: 24 mm

ØD2: 60.3 mm

Material and weight

Material: Kst / INOX / Alu

Weight: 2.8 kg

Loads

Breaking load horizontal: 27 kN

Tightening torque for bolts and hex-nuts M8: 17 Nm

Tightening torque for bolts M12: 40 Nm

Applicable standards

DIN EN 50119

DIN EN 50124-1

DIN EN 50151

CEI / IEC 60060-1

Function

Insulator body for fastening to pipes, in medium to narrow bends. Continuously adjustable double suspension eye allowing the attachment of all type curve rail.

Specifications

Operating voltage: max. 1500 V DC

Comments

The application in overhead contact lines requires a wide insulation of the support structure to the support bases.

Directly mountable to circular profiles of any material.

Optional: Exchanging the u-bolt allows mounting to pipes Ø45 – 80mm.

The suspension can be mounted to cross-spans or ceilings by exchanging the clamp.