

# Line insulator to steel cable KUSYS type 2 with simple suspension eye and suspension eye

Item number C2378-02

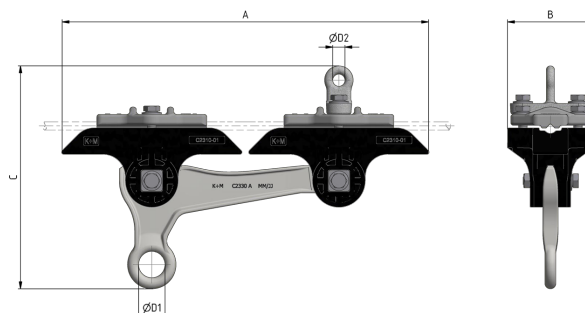
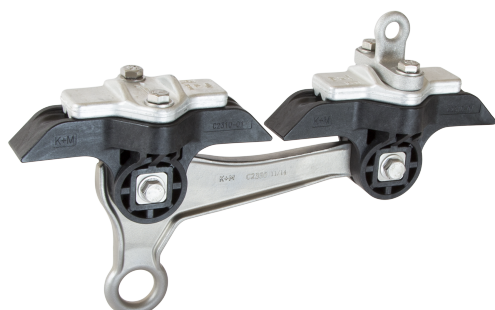

## Dimensions

A: 334 mm  
B: 78 mm  
C: 202 mm  
ØD1: 24 mm  
ØD2: 11 mm

## Material and weight

Material: Kst / INOX / Alu  
Weight: 1.8 kg

## Loads

Slipping load: 18 kN  
Bruchlast der Aufhängeöse: 12 kN  
Tightening torque for bolts and hex-nuts M8: 17 Nm

## Applicable standards

DIN EN 50119  
DIN EN 50124-1  
DIN EN 50151

CEI / IEC 60060-1

## Function

Insulator body for fastening to cross-spans, in medium to narrow bends. With cable yoke. Suspension for tramway hanger wire or steady arms.

## Specification

Cable diameter: 7.0 - 9.5 mm  
Operating voltage: max. 1500 V DC

## Comments

The application in overhead contact lines requires a wide insulation of the support structure to the support bases. Clamping is possible on the following cables: steel hot-dip galvanised and steel/copper. Clamps for other cable diameters on request. The suspension can be mounted to pipes or ceilings by exchanging the clamp.