

Line insulator to steel cable KUSYS type 2 with suspension threaded bolt M16 rigid

Item number C2381-01

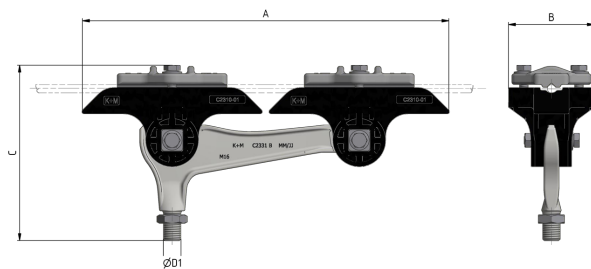

Dimensions

A: 334 mm

B: 78 mm

C: 159 mm

ØD1: M16

Material and weight

Material: Kst / INOX / Alu

Weight: 1.7 kg

Loads

Breaking load horizontal: 7.5 kN

Tightening torque for bolts and hex-nuts M8: 17 Nm

Applicable standards

DIN EN 50119

DIN EN 50124-1

DIN EN 50151

CEI / IEC 60060-1

Function

Insulator body for fastening to cross-spans, in medium to narrow bends. Threaded bolt rigid, suspension allowing the attachment of various railway, tramway and trolley bus components.

Specification

Operating voltage: max. 1500 V DC

Cable diameter: 7.0 - 9.5 mm

Comments

The application in overhead contact lines requires a wide insulation of the support structure to the support bases.

Clamping is possible on the following cables: steel hot-dip galvanised and steel/copper.

The suspension can be mounted to pipes or ceilings by exchanging the clamp.