

Adjustable steady arm, type 54, with thread 5/8", SST

Item number D1666-02

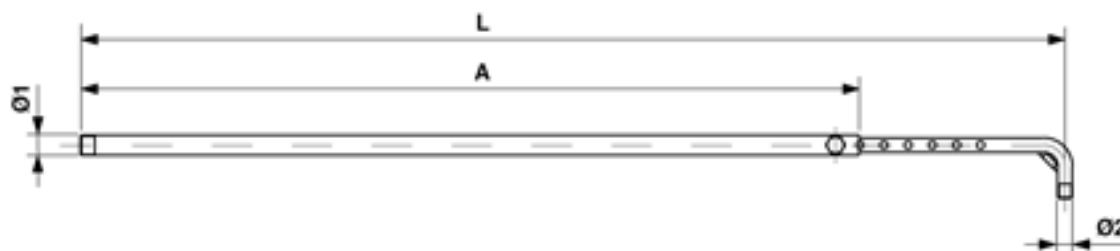

Dimensions

A: 500 mm
L min.: 600 mm
Ø1: G0.5"
L max.: 900 mm
Ø2: 5/8"

Material and weight

Weight: 1.350 kg
Material: SST

Comments

- Steady arm pipe (SST) for types 44-194: part no. D1665-01 to D1665-09
- Regulation rod (SST) for types 44-54: part no. D1664-01 - Clevis eye G0.5" for steady arm connection (SST) part no. E0109-01 (to be ordered separately)
- Connection cap G0.5" for steady arm direct to porcelain insulator or to pole (SST) part no. E3260-01 (to be ordered separately)
- Fork clevis G0.5" for steady arm connection (Bz) part no. E2839-01 (to be ordered separately)
- Other lengths on request