

# Adjustable steady arm, type 174, with thread 5/8", SST

Item number D1666-08

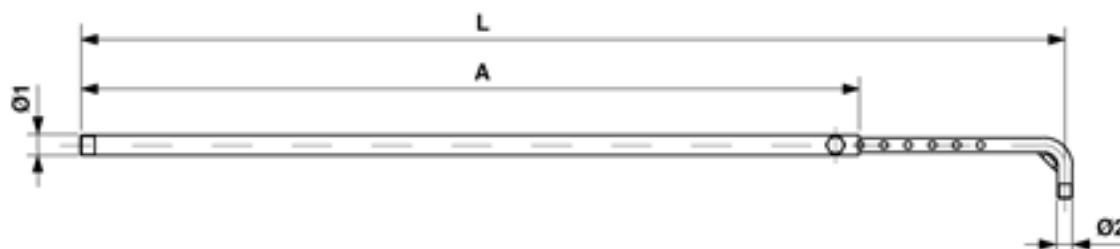

## Dimensions

Ø2: 5/8"

Ø1: G0.5"

A: 1700 mm

L max.: 2100 mm

L min.: 1800 mm

## Material and weight

Weight: 3.200 kg

Material: SST

## Comments

- Steady arm pipe (SST) for types 44-194: part no. D1665-01 to D1665-09
- Regulation rod (SST) for types 69-194: part no. D1664-02 - Clevis eye G0.5" for steady arm connection (SST) part no. E0109-01 (to be ordered separately)
- Connection cap G0.5" for steady arm direct to porcelain insulator or to pole (SST) part no. E3260-01 (to be ordered separately)
- Fork clevis G0.5" for steady arm connection (Bz) part no. E2839-01 (to be ordered separately)
- Other lengths on request