

Channel support bracket (left and right) for disconnect switch Duplex and arcing horns, for channel support

Item number D2525-01

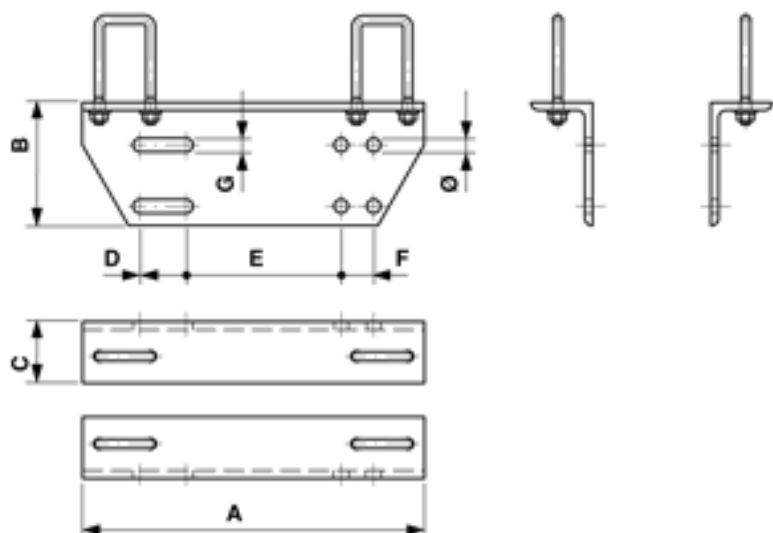

Dimensions

B: 160 mm

C: 80 mm

Ø: 18 mm

A: 445 mm

G: 18 mm

D: 75 mm

E: 202 mm

F: 33 mm

Material and weight

Material: STL HDG

Comments

- For poles HEB 180-260

- U-bolt Ø= 16 mm Part-no. E0888-... (4 pcs.) (to be ordered separately)