

Pipe attachment simple with lift limiter, complete, to pipe $\varnothing = 38$ mm, for 1 steady arm

Item number D2705-01

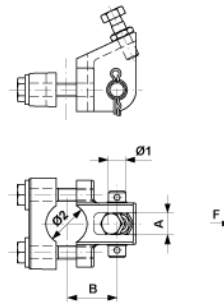
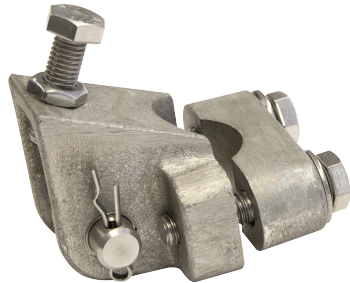

Dimensions

$\varnothing 2$: 38 mm

A: 20 mm

$\varnothing 1$: 16 mm

B: 48 mm

Material and weight

Weight: 0.675 kg

Material: Al/SST

Loads

Breaking load F: 30 kN