

# In-between insulator with pipe adapter complete, composite, to pipe G2.5"

Item number D3042-01

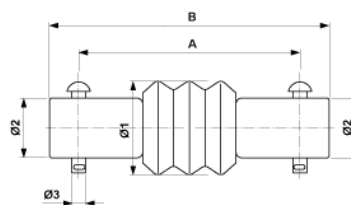

## Dimensions

A: 190 mm  
B: 240 mm  
Ø3: 12 mm  
Ø1: 80 mm  
Ø2: 66.8 mm

## Material and weight

Weight: 1.750 kg

## Loads

Breaking load: 30 kN

## Specification

Operating voltage: max. 3.000 kV  
Minimum creeping distance: 92 mm for insulator

## Comments

- Connection parts in Al
- Pin and cotter pin SST
- Other pipe connector Ø on request