

Drop bracket clamp for steady arms, complete, 1 steady arm, to pipe 2.5"

Item number D3124-03

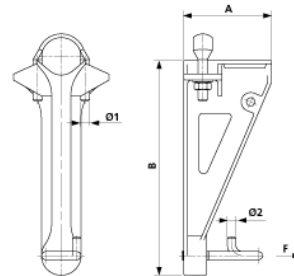

Dimensions

B: 285 mm
A: 115 mm
Ø1: M12
Ø2: 10.900 mm

Material and weight

Weight: 1.120 kg
Material: Al/SST

Loads

Breaking load F: 5.6 kN