

Drop bracket clamp for steady arms, complete, 1 steady arm, to pipe $\varnothing = 70$ mm

Item number D3124-05

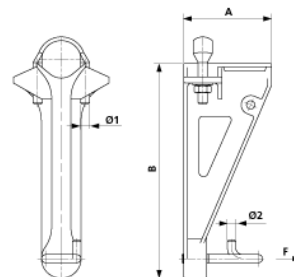

Dimensions

B: 285 mm

A: 115 mm

$\varnothing 1$: M12

$\varnothing 2$: 10.900 mm

Material and weight

Weight: 1.120 kg

Material: Al/SST

Loads

Breaking load F: 5.6 kN