

Drop bracket clamp for steady arms, complete, 2 steady arm, to pipe $\varnothing = 70$ mm

Item number D3138-05

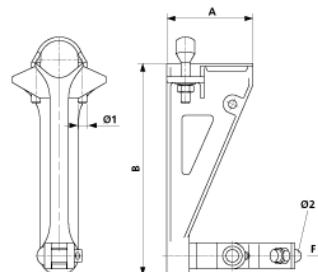

Dimensions

B: 285 mm
A: 115 mm
Ø2: 12 mm
Ø1: M12

Material and weight

Weight: 1.950 kg
Material: Al/SST

Loads

Breaking load F: 11.3 kN