

# Clevis tongue with pins

Item number E0112-01

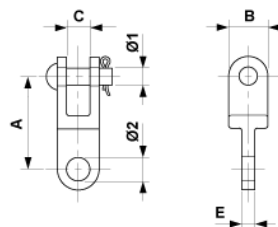

## Dimensions

B: 30 mm  
C: 18 mm  
E: 10 mm  
A: 71 mm  
Ø2: 18 mm  
Ø1: 13 mm

## Material and weight

Weight: 0.340 kg  
Material: STL HDG

## Loads

Breaking load: 50 kN