

Clevis complete, with thread M16

Item number E3249-01

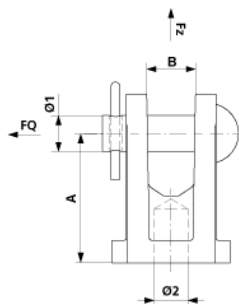

Dimensions

B: 21 mm
Ø1: 16 mm
Ø2: M16
A: 57.5 mm

Material and weight

Material: Al/SST
Weight: 0.260 kg

Loads

Breaking load F across: 4 kN
Breaking load F on traction: 38 kN

Specification

Thread depth: 18 mm

Comments

- With pins 16 x 50 and cotter pin SST
- Use: Multifunction for various ARCAS parts