

Insulator with clevis eye and clevis fork complete, composite, $\varnothing = 80$ mm

Item number E3301-02

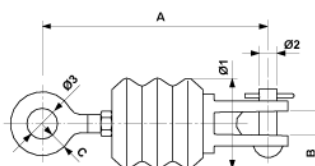

Dimensions

A: 200 mm

$\varnothing 2$: 16 mm

$\varnothing 1$: 80 mm

C: 14.5 mm

$\varnothing 3$: 27 mm

B: 21.5 mm

Material and weight

Weight: 1.240 kg

Loads

Breaking load: 30 kN

Specification

Operating voltage: max. 3.000 kV

Minimum creeping distance: 120 mm

Comments

- Connection parts in Al/STL HDG
- Pin and cotter pin SST