

Line insulator KUSYS1 complete suspension simple eye, to pipe 2.5"

Item number C2369-03

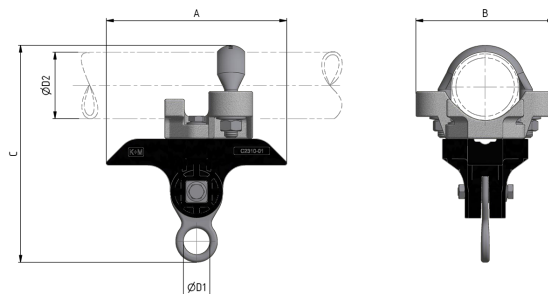

Dimensions

A: 164 mm

B: 126 mm

C: 196 mm

ØD1: 24 mm

ØD2: 2.5" (76.1) mm

Material and weight

Material: Kst / INOX / Alu

Weight: 1.21 kg

Loads

Breaking load vertical: 4.2 kN

Tightening torque for bolts and hex-nuts M8: 17 Nm

Tightening torque for bolts M12: 40 Nm

Applicable standards

DIN EN 50119

DIN EN 50124-1

DIN EN 50151

CEI / IEC 60060-1

Function

Insulator body for fastening to pipes in straight segments or slight bends. Suspension for tramway hanger wire or steady arms.

Specifications

Operating voltage: max. 1500 V DC

Comments

The application in overhead contact lines requires a wide insulation of the support structure to the support bases.

Optional: Exchanging the u-bolt allows mounting to pipes Ø45 - 80mm mm.

The suspension can be mounted to cross-spans or ceilings by exchanging the clamp. Directly mountable to circular profiles of any material.