

Line insulator to pipe 1.5" KUSYS type 1 with simple suspension eye

Item number C2369-01

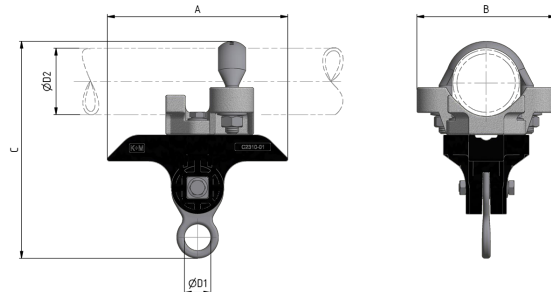

Dimensions

A: 164 mm
B: 126 mm
C: 196 mm
ØD1: 24 mm
ØD2: 60.3 mm

Material and weight

Material: Kst / INOX / Alu
Weight: 1.17 kg

Loads

Breaking load vertical: 4.2 kN
Tightening torque for bolts and hex-nuts M8: 17 Nm
Tightening torque for bolts M12: 40 Nm

Applicable standards

DIN EN 50119

DIN EN 50124-1
DIN EN 50151
CEI / IEC 60060-1

Function

Insulator body for fastening to pipes in straight segments or slight bends. Suspension for tramway hanger wire or steady arms.

Specifications

Operating voltage: max. 1500 V DC

Comments

The application in overhead contact lines requires a wide insulation of the support structure to the support bases.
Optional: Exchanging the u-bolt allows mounting to pipes Ø45 – 80mm mm.
The suspension can be mounted to cross-spans or ceilings by exchanging the clamp. Directly mountable to circular profiles of any material.