

# Line insulator to pipe 1.5" KUSYS type 1 with suspension threaded bolt M16 rigid

Item number C2372-01

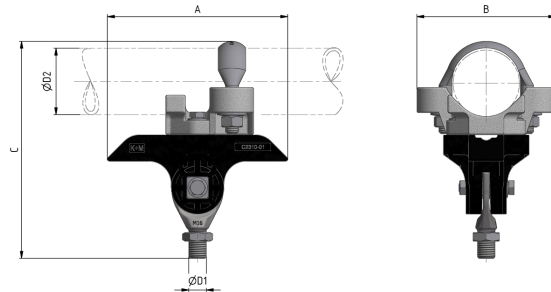

## Dimensions

A: 164 mm  
B: 126 mm  
C: 197 mm  
ØD1: M16  
ØD2: 2" (60.3 mm)

## Material and weight

Material: Kst / INOX / Alu  
Weight: 1.67 kg

## Loads

Breaking load horizontal: 4.6 kN/ H: 90 mm  
Tightening torque for bolts and hex-nuts M8: 17 Nm  
Tightening torque for bolts M12: 40 Nm

## Applicable standards

DIN EN 50119

DIN EN 50124-1  
DIN EN 50151  
CEI / IEC 60060-1

## Function

Insulator body for fastening to pipes in straight segments or slight bends. Rigid threaded bolt suspension allowing the attachment of various railway, tramway and trolley bus components.

## Specifications

Operating voltage: max. 1500 V DC

## Comments

The application in overhead contact lines requires a wide insulation of the support structure to the support bases.  
Optional: Exchanging the u-bolt allows mounting to pipes Ø45 – 80mm mm. The suspension can be mounted to cross-spans or ceilings by exchanging the clamp.